

## **RULES FOR VISITING BANDS, MUSICIANS AND DJ'S - BY ACCEPTING A BOOKING TO WORK AT MICKLETON HILLS FARM ALL BANDS, MUSICIANS AND DJ'S AGREE TO BE BOUND BY THESE RULES**



**WE WELCOME ANY BAND, MUSICIAN OR DJ AT MICKLETON HILLS FARM. WE REQUIRE ALL BANDS, MUSICIANS & DJ'S TO COMPLETE OUR *SUPPLIER BOOKING FORM* PRIOR TO CONFIRMING A BOOKING.**

**ANY VISITING BAND/MUSICIAN/DJ MUST BE COVERED BY THEIR OWN INSURANCE, HAVE THEIR OWN PUBLIC LIABILITY INSURANCE AND COMPLY WITH ALL HEALTH & SAFETY ACTS.**



### **HOW THE VENUE WORKS**

All bands, musicians and DJ's must connect and play through our system.\*  
Connection is via 2 balanced XLR line level inputs (left and right)

Any visiting bands, musicians or DJs must provide their own front end, mixer, microphones and stage monitors. Our system works with balanced line level outputs. If you have a powered mixer it must have line level outputs to connect to our system. All brought equipment must show a current PAT test sticker.

Mickleton Hills Farm has installed its own ceiling mounted, state of the art Yamaha in-house sound system. This plays across our entire venue and connects both barns with inbuilt zoning and maximum decibel limiters. Our in house sound system is designed with a maximum output volume per speaker. Our sound limiter will reduce the noise output rather than cut the power. This means our system will never cut out.

Our limiter is set in line with our noise restriction notice as all recorded and live music must not be played above a decibel level set by Cotswold district council. The system has a limit of 92DB LEQ measured in the centre of the barn over a 15 minute period.

Our speakers are all located inside and music can only be played outside if it is unamplified. Outside music must finish by 8pm. All other music must finish at midnight sharp.

Please see the full sound specification at the end of this document for full sound system and equipment provided. Please contact Mickleton Hills Farm with any questions on our system in advance of booking.

*\*During the ceremony our system plug in points may be unavailable. Please contact Mickleton Hills Farm in relation to equipment if you are playing during the ceremony.*



### **ACCESS**

- Access to the barns is available from 10am on the day of the wedding.
- Please let Mickleton Hills Farm know your time of arrival. Closest access to the performance area is via a set of locked gates which can be opened with prior knowledge.
- The barns must be cleared and locked by 00:30.
- A staff room and staff changing room is located behind the kitchen. This room is shared with other suppliers.
- All staff accept full responsibility for their belongings and equipment when attending or setting-up an event at Mickleton Hills Farm. We accept no responsibility for any personal or commercial property brought to or stored at the venue.

## SAFETY

- The band, musician or DJ is responsible for all members they bring onto site throughout the event. A sign in sheet must be available on request.
- One band member, musician or DJ will be given a full walkthrough of the site on arrival and is responsible for passing this information onto their colleagues.
- Smoking is not permitted within any of our buildings under any circumstances. Smoking is permitted outside the buildings, in a designated area and staff must ensure that cigarettes are extinguished before returning to the buildings. Electronic cigarettes are also prohibited within our buildings.
- Windows and doors must be kept clear of all equipment and displays in order to allow a safe exit in the event of a fire.
- In the event of a fire the band, musician or DJ is responsible for checking all their members are accounted for and reporting any missing persons to the Mickleton Hills Farm team.
- Mickleton Hills Farm operates a zero tolerance towards alcohol and substance abuse. Anyone found in possession or under the influence of illegal drugs or substances will be reported to the police and asked to leave the premises.
- All band members, musicians or DJs agree to be bound by all reasonable instructions of authorised representatives of Mickleton Hills Farm in relation to the conduct of the function. Mickleton Hills Farm reserves the right to require any person to leave if he/she is causing a disturbance, annoying other guests or staff or is behaving in an unacceptable manner.



## PARKING

- Parking is available on-site for your cars. Please keep these to a minimum and let the Mickleton Hills Farm team know of your requirements.
- We ask you to enter and leave our premises at a speed of no more than 10mph. Drivers must respect all public rights of way and must be aware of walkers, riders and animals passing through our site.
- When leaving the premises you must be considerate to local residents and leave the premises as quietly as possible.
- All cars are parked at the owners' own risk. Mickleton Hills Farm is not liable for any loss or damage caused to any vehicle whilst on site. All cars must be removed from the venue by 00.30 on the day of the wedding.



## CLEANING & RUBBISH

- After use the barns must be left in the clean and tidy condition in which they were found
- All rubbish and recycling in relation to the band/musician/DJ must be removed and disposed of.
- The staff room must be left in a clean and tidy manner if used. Food plates and cutlery must be returned to the kitchens.

### SOUND SYSTEM LAYOUT

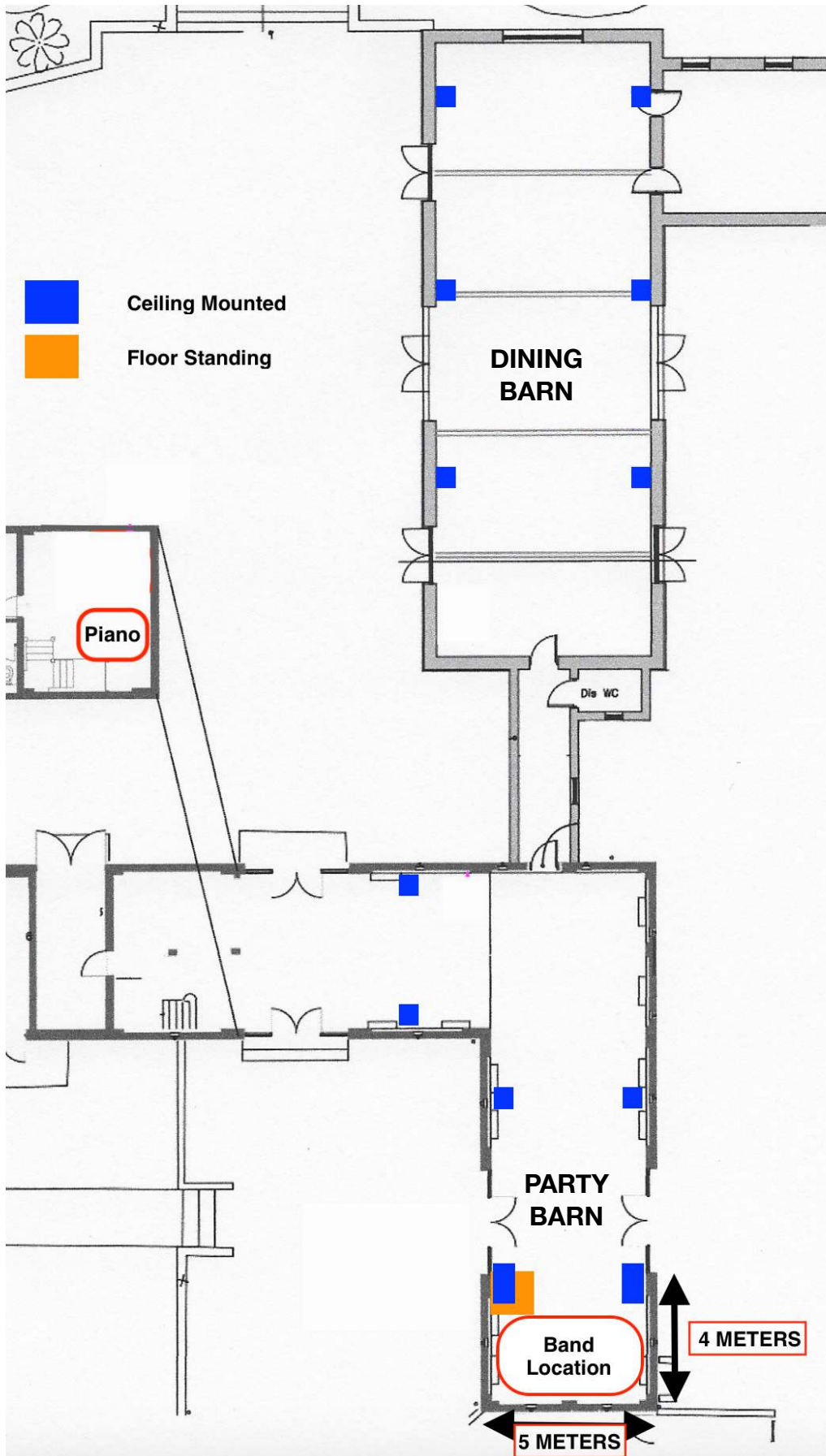



## SYSTEM OUTLINE

The main FOH system is a two way sound system comprising of

2 x Twin 8 inch and 1.75 inch high-frequency driver top speakers  
1 x A twin 15 inch bass bin

There are infill speakers spread out down the barn to give even coverage for the length of the barn.

The system has a limit of 92dB LEQ measured in the centre of the barn over a 15 minute time period.

There are 6 x speakers in the dining barn for speeches and a background level feed of the party barn output for the evening.



## SYSTEM INPUT

2 x Balanced XLR Line Level Inputs - Positioned *Stage Left Band Location - Party Barn*



## SPEAKERS

### MAIN FOH SPEAKERS - PARTY BARN

2 X YAMAHA IF2208 TOP SPEAKERS

Power Rating: PGM 400w, Max 800w

Continuous SPL (calculated) 118dB

1 x Yamaha IS1215 Bass Speaker - floor mounted

Power Rating: PGM 1400w x2, Max 2800w x2

Continuous SPL (calculated) 128dB

### FOH IN FILL SPEAKERS - PARTY BARN

2 x Yamaha VXS5

Power Rating: PGM 150w

Peak SPL (calculated) 100dB

### BAR IN FILL SPEAKERS - PARTY BARN

2 x Yamaha VXS5

Power Rating: PGM 150w

Peak SPL (calculated) 100dB

### BACKGROUND MUSIC SPEAKERS - DINING BARN

6 x Yamaha VXS5

Power rating: PGM 150w

Peak SPL (calculated) 100dB



## ELECTRONICS

1 x Yamaha MTX Multi Zone Digital Sound Processor

1 x Yamaha XMV Series Power Amplifier

1 x Yamaha PX8 Power Amplifier

1 x Yamaha PX10 Power Amplifier

*FOH Infills, Bar Infills & Dining Barn BGM*

*FOH Top Speakers*

*Bass Speaker*

## CONTACT AND DIRECTIONS

MICKLETON HILLS FARM  
FURZE LANE  
CHIPPING CAMPDEN  
GLOUCESTERSHIRE  
GL55 6LJ

[INFO@MICKLETONHILLSFARM.COM](mailto:INFO@MICKLETONHILLSFARM.COM)

01386 841939

CONTACT - DAVID OR SAMMY

